

RoHS

F

E

D

C

B

A

Circuit 1

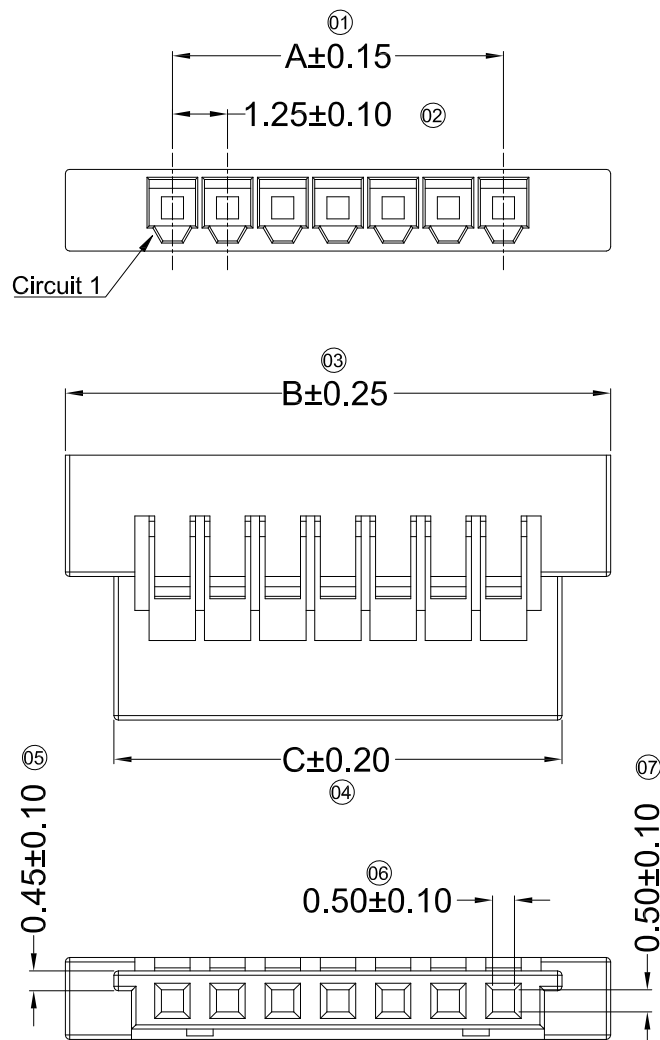

4P~30P Double Salient  
Scale 1:5

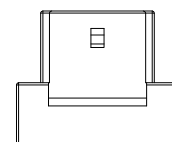

2P~3P Single Salient  
Scale 1:5

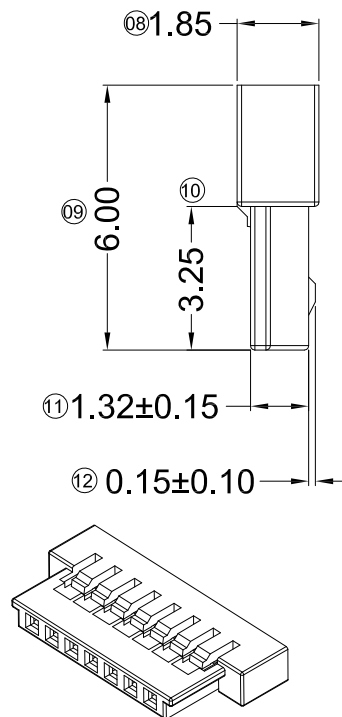

■ Specifications :

- Voltage rating: 200V AC / DC
- Current rating: 1A AC / DC
- Withstanding voltage: 500V AC/minute
- Temperature range: -40° ~+105°
- Insulation resistance: ≥100MΩ
- Contact resistance: ≤40mΩ
- After environmental testing: ≤80mΩ
- Suitable GYA Terminal: A1255T
- Mates With GYA Wafer: A1255W

A1255 H X - 1\*XX X - N0 XX XX  
① ②③ ④⑤ ⑥ ⑦ ⑧

- ① Series No.
- ② Category: H-HSG
- ③ Connector type: Blank-ordinary
- ④ Row No.-Pin No per row: 1\*XX-1\*02P~1\*30P
- ⑤ Special No.:
- ⑥ Plastic material: N0-PA66 94V-0
- ⑦ Color: Blank-natural color
- ⑧ Blank-ROHS ; HF-Halogen free

Poles	Dimensions(mm)			Poles	Dimensions(mm)		
	AB		C		AB		C
02	1.25	6.10	3.90	11	12.50	17.35	15.15
03	2.50	7.35	5.15	12	13.75	18.60	16.40
04	3.75	8.60	6.40	13	15.00	19.85	17.65
05	5.00	9.85	7.65	14	16.25	21.10	18.90
06	6.25	11.10	8.90	15	17.50	22.35	20.15
07	7.50	12.35	10.15	16	18.75	23.60	21.40
08	8.75	13.60	11.40	20	23.75	28.60	26.40
09	10.00	14.85	12.65	25	30.00	34.85	32.65
10	11.25	16.10	13.90	30	36.25	41.10	38.90

GENERAL TOLERANCE

.X ±0.30

.XX ±0.20

.XXX ±0.10

X.° ±2°

PROJECT



**GYA**  
Connectors

东莞市国亚电子有限公司  
Dong Guan Guo Ya Connectors co., Ltd.

APPROVAL

Yangzhengguo

CHECK

Yangzhengyi

DRAWN

Lvtiansheng

DATE

2016/08/26

PART NO.:

A1255H-1xXX-N0XX

TITLE: 1.25mm CrImp Style Connectors

UNIT	SCALE	SHEET	REV	NUMBER
mm	1:1	1/1	A0	A-022

DATE	REV	ECN NO.	DESCRIPTION	MODIFY	APPROVAL
------	-----	---------	-------------	--------	----------

RoHS

成品工程图

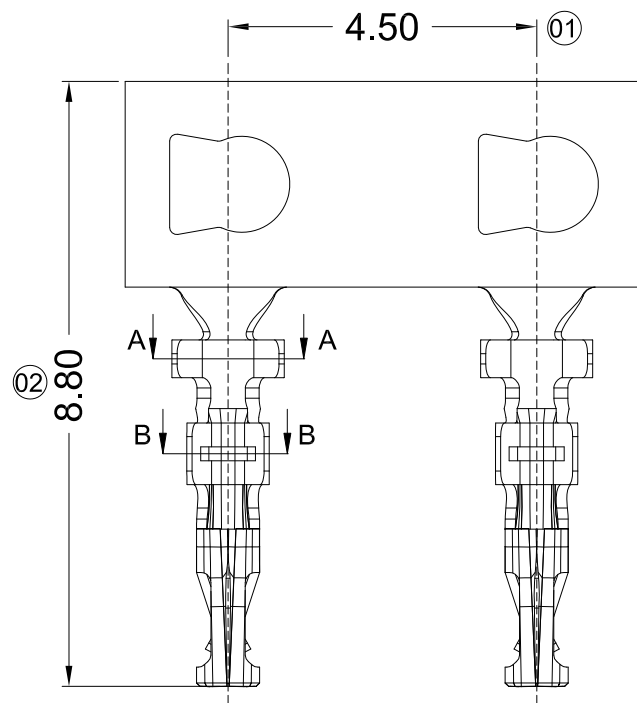
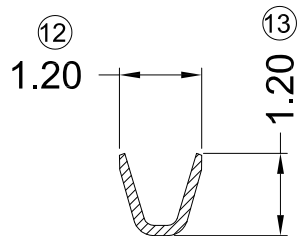
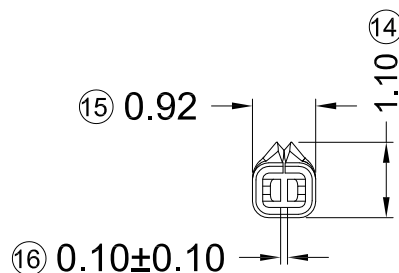
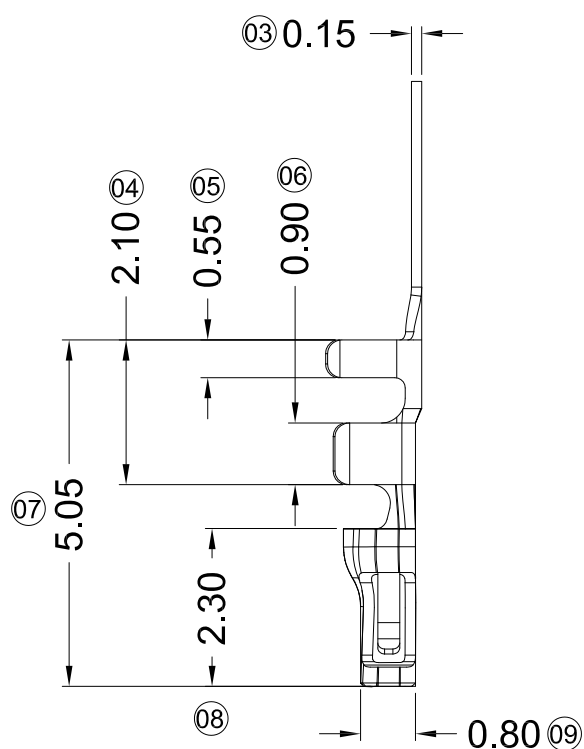
SECTION A-A  
SCALE 1:1SECTION B-B  
SCALE 1:1

## ■ Specifications :

- Voltage rating: 200V AC / DC
- Current rating: 1A AC / DC
- Withstanding voltage: 500V AC/minute
- Temperature range: -40° ~+105°
- Insulation resistance:  $\geq 100M\Omega$
- Contact resistance:  $\leq 40m\Omega$
- After environmental testing:  $\leq 80m\Omega$
- Material(Pin): Phosphor bronze
- Mates With GYA Housing : A1255H

A1255 T X - P XX X - X

(1) (2) (3) (4) (5) (6) (7)

- ① Series Number
- ② Category: T-terminal
- ③ Shape: Blank-ordinary
- ④ Material: P-Phosphor bronze
- ⑤ Plating Code:
  - V01- Gold Flash
  - SN-Bright tin plating
- ⑥ Plating method:
  - Blank-Stamping before plating
- ⑦ Mold No./Mark/Special No.

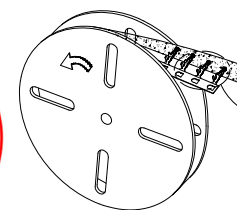

卷装方式

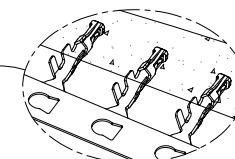

SCALE 4:1

## GENERAL TOLERANCE

.X  $\pm 0.20$ .XX  $\pm 0.15$ .XXX  $\pm 0.08$ X.°  $\pm 2^\circ$ 

PROJECT

GYA  
Connectors东莞市国亚电子有限公司  
Dong Guan Guo Ya Connectors co., Ltd.

APPROVAL

Yangzhengguo

CHECK

Yangzhengyi

DRAWN

Lvtiansheng

DATE

2016/08/26

PART NO.:

A1255T-PXX

TITLE: 1.25mm Crimp Style Connectors

UNIT

mm

SCALE

1:1

SHEET

1/1

REV

A0

NUMBER

A-014

RoHS



■ Specifications :

- Voltage rating: 200V AC / DC
- Current rating: 1A AC / DC
- Withstanding voltage: 500V AC/minute
- Temperature range: -40° ~+105°
- Insulation resistance:  $\geq 100M\Omega$
- Contact resistance:  $\leq 40m\Omega$
- After environmental testing:  $\leq 80m\Omega$
- Material(Pin And Solder Tabs): Brass
- Mates With GYA Housing: A1255H-1\*XX

A1255 W R S - 1\*XX X - LP XX XX

① ② ③ ④ ⑤ ⑥ ⑦ ⑧ ⑨

① Series No.

② Category: W-wafer

③ Connector type: R- Right Angle 90°

④ Mouting type: S-SMT

⑤ Row No.-Pin No per row: 1\*XX-02P~06P, 08P;

⑥ Special No.:

⑦ Material: LP-LCP 94V-0

⑧ Plating Code: V01-Gold Flash;  
SW-Matte Tin plating

⑨ Color: Blank-natural color

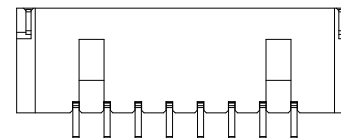
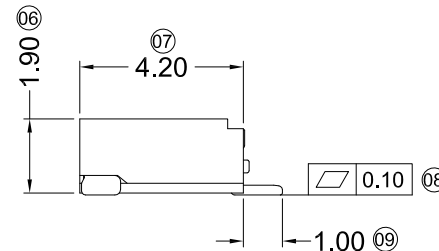
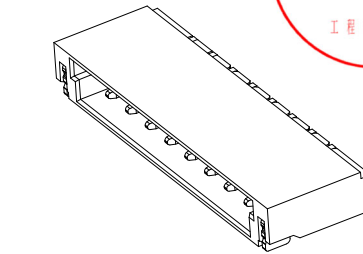

8P Double Hole  
Scale 1:0.8

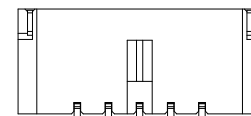

2P~6P Single Hole  
Scale 1:0.8

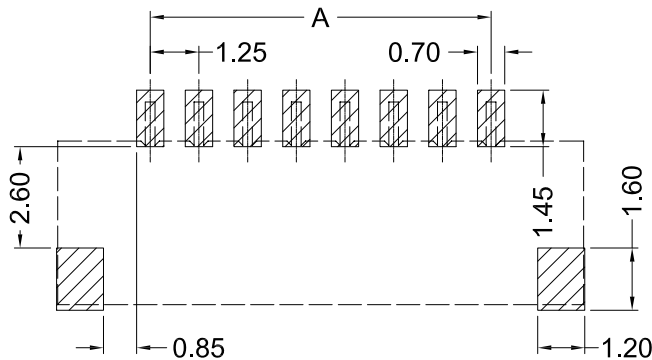
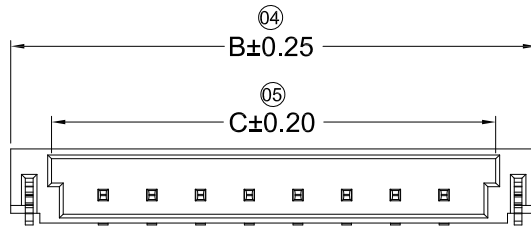
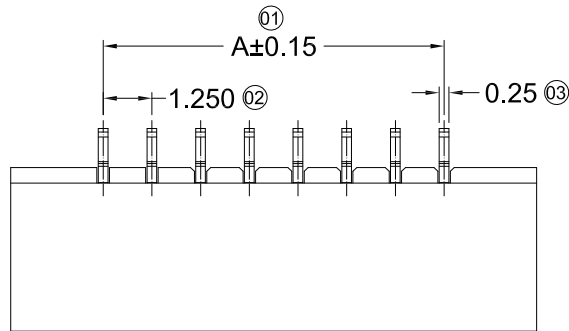

Recommended P.C.B Layout  
General Tolerance  $\pm 0.05$

Poles	Dimensions(mm)		
	A	B	C
02	1.25	6.00	3.90
03	2.50	7.25	5.15
04	3.75	8.50	6.40
05	5.00	9.75	7.65
06	6.25	11.00	8.90
08	8.75	13.50	11.40

GENERAL TOLERANCE

.X  $\pm 0.30$

.XX  $\pm 0.20$

.XXX  $\pm 0.10$

X.°  $\pm 2^\circ$

PROJECT



**GYA**  
Connectors

东莞市国亚电子有限公司  
Dong Guan Guo Ya Connectors co., Ltd.

APPROVAL

Yangzhengguo

CHECK

Yangzhengyi

DRAWN

Lvtiansheng

DATE

2016/08/26

PART NO.

A1255WRS-1\*XX-LPXX

TITLE

1.25mm Crimp Style Connectors

UNIT

mm

SCALE

1:1

SHEET

1/1

REV

A0

NUMBER

A-082

DATE

REV

ECN NO.

DESCRIPTION

MODIFY

APPROVAL

RoHS

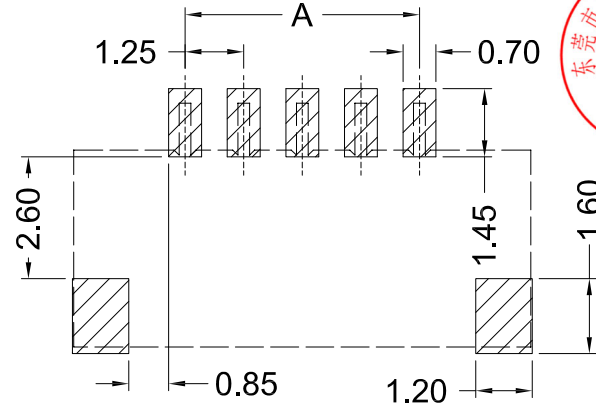
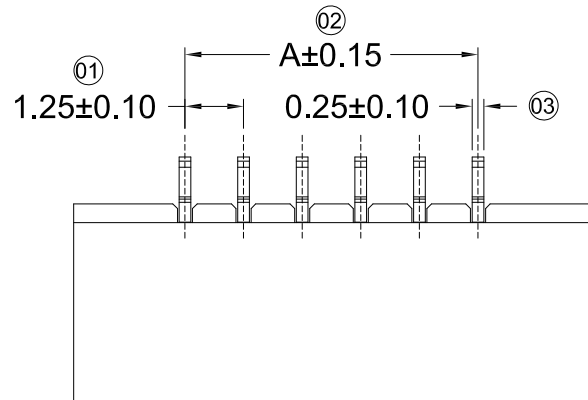

Recommended P.C.B Layout  
General Tolerance±0.05

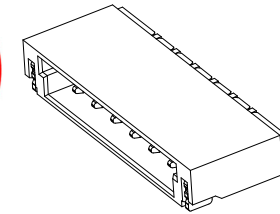
**Specifications :**

- Voltage rating: 200V AC / DC
- Current rating: 1A AC / DC
- Withstanding voltage: 500V AC/minute
- Temperature range: -40° ~+105°
- Insulation resistance: ≥100MΩ
- Contact resistance: ≤40mΩ
- After environmental testing: ≤80mΩ
- Material(Pin And Solder Tabs):Brass
- Mates With GYA Housing : A1255H

A1255 W R S - 1\*XX T - LP XX XX  
① ② ③ ④ ⑤ ⑥ ⑦ ⑧ ⑨

- ① Series No.  
② Category: W-wafer  
③ Connector type: R- Right Angle 90°  
④ Mouting type: S-SMT  
⑤ Row No.-Pin No per row 1\*XX-04P~06P  
⑥ Special No.: T-Double Dole  
⑦ Material: LP-LCP 94V-0  
⑧ Plating Code: V01-Gold Flash;  
SW-Matte Tin plating  
⑨ Color: Blank-natural color

Poles	Dimensions(mm)		
	A	B	C
04	3.75	8.50	6.40
05	5.00	9.75	7.65
06	6.25	11.00	8.90

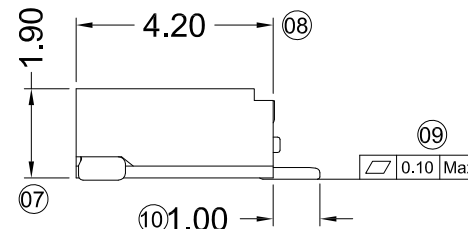
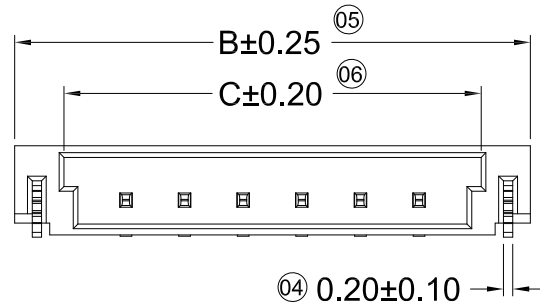

4P~6P Double

GENERAL TOLERANCE

.X ±0.30

.XX ±0.20

.XXX ±0.10

X.° ±2°

PROJECT



**GYA**  
Connectors

东莞市国亚电子有限公司  
Dong Guan Guo Ya Connectors co., ltd.

APPROVAL

Yangzhengguo

CHECK

Yangzhengyi

DRAWN

Lvtiansheng

DATE

2016/08/26

PART NO.:

A1255WRS-1\*XXT-LPXX

TITLE: 1.25mm Crimp Style Connectors

UNIT	SCALE	SHEET	REV	NUMBER
mm	1:1	1/1	A0	A-082

DATE REV ECN NO. DESCRIPTION

MODIFY APPROVAL