

RoHS

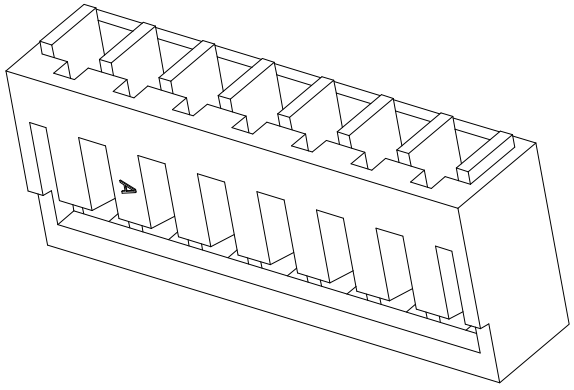
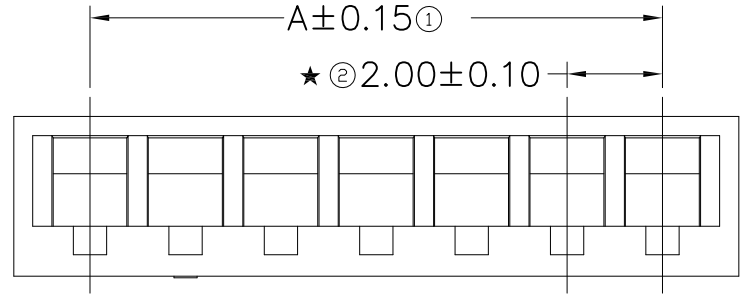

Specifications

- Voltage rating: 250V AC / DC
- Current rating: 2A AC / DC
- Withstanding voltage: 800V AC/minute
- Temperature range: -40° ~ +105°
- Insulation resistance: ≥1000MΩ
- Suitable GYA Terminal: 9020TV
- "★" Critical dimension

9020 H V-XX X-NO XX
① ②③ ④ ⑤⑥ ⑦

- ① Series No.
- ② Category : H-HSG
- ③ Appearance type : V-Straight 180°
- ④ Row No.-Pin No.: XX-02P~16P
- ⑤ Special No.: Blank-Ordinary
- ⑥ Material : N0-PA66 UL 94V-0
- ⑦ Color: Blank-Natural Color
HF-Halogen Free

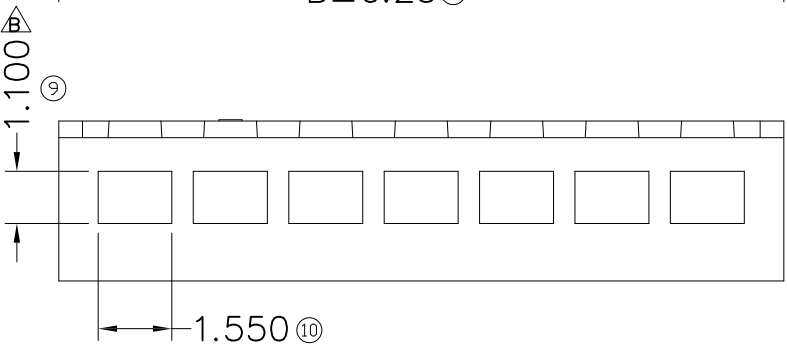
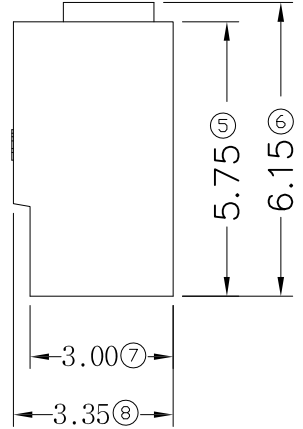
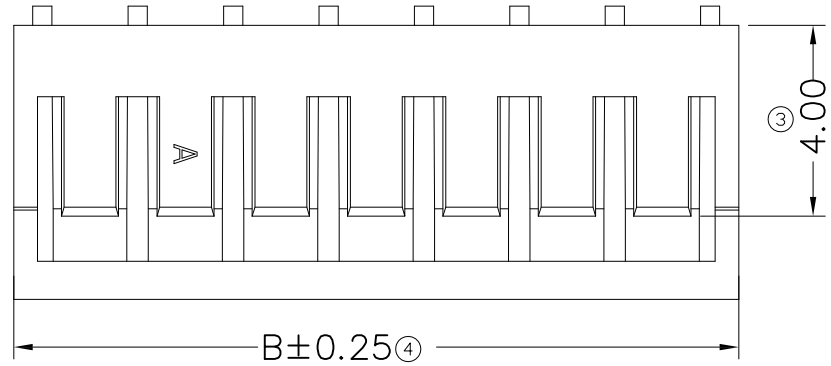

Poles	Dimensions (mm)		Poles	Dimensions (mm)	
	A	B		A	B
02	2.00	5.20	10	18.00	21.20
03	4.00	7.20	11	20.00	23.20
04	6.00	9.20	12	22.00	25.20
05	8.00	11.20	13	24.00	27.20
06	10.00	13.20	14	26.00	29.20
07	12.00	15.20	15	28.00	31.20
08	14.00	17.20	16	30.00	33.20
09	16.00	19.20			



					GENERAL TOLERANCE .X ±0.30 .XX ±0.20 .XXX ±0.10 X.* ±2°		GYA 东莞市国亚电子有限公司 Connectors Dong Guan Guo Ya Connectors co., ltd.			PARTNO. 9020HV-XX-NOXX			
					PROJECT 		APPROVAL Yangzhengguo			CHECK Yangzhengyi			
					DATE 2016/08/26		DRAWN Lviansheng			DATE			
					UNIT mm			SCALE 1:1			SHEET 1/1		
					REV A0			NUMBER XXXX					

DATE	REV	ECN NO	DESCRIPTION	MODIFY	APPROVAL	PROJECT	APPROVAL	CHECK	DRAWN	DATE	UNIT	SCALE	SHEET	REV	NUMBER
1											mm	1:1	1/1	A0	XXXX

RoHS

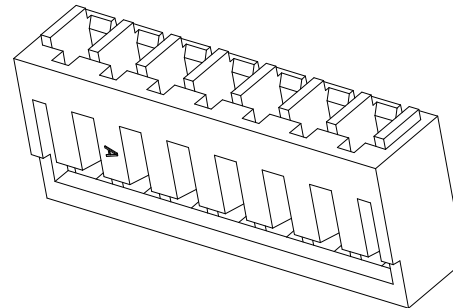
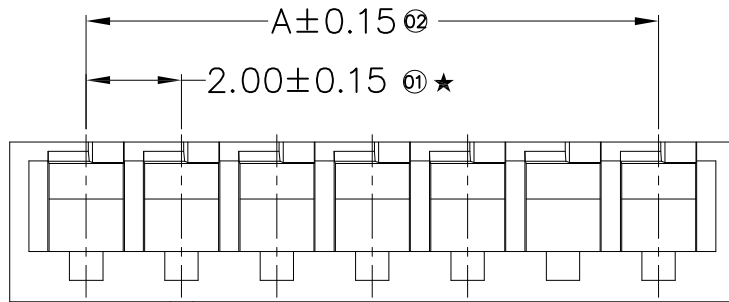

■ Specifications

- Voltage rating: 250V AC / DC
- Current rating: 2A AC / DC
- Withstanding voltage: 800V AC/minute
- Temperature range: -40° ~ +105°
- Insulation resistance: ≥1000MΩ
- Suitable GYA Terminal: 9020TR
- "★" Critical dimension

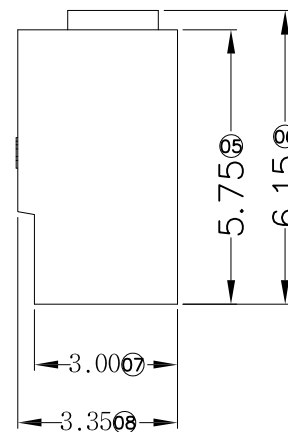
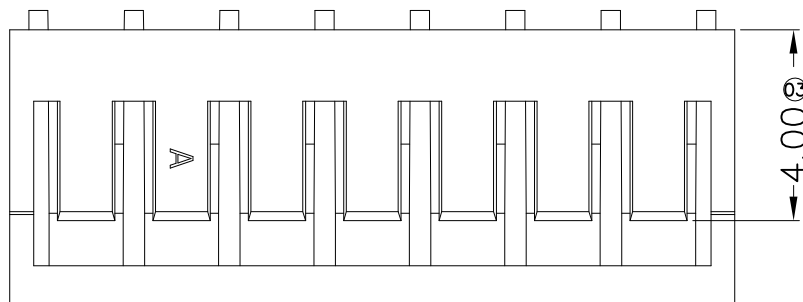

9020 H R-XX X-NO XX
① ②③ ④ ⑤⑥ ⑦

- ① Series No.
- ② Category : H-HSG
- ③ Appearance type : R-Right Angle 90°
- ④ Row No.-Pin No.: XX-02P~16P
- ⑤ Special No.: Blank-Ordinary
- ⑥ Material : NO-PA66 UL 94V-0
- ⑦ Color:Blank-Natural Color
HF-Halogen Free

Poles	Dimensions (mm)		Poles	Dimensions (mm)	
	A	B		A	B
02	2.00	5.20	10	18.00	21.20
03	4.00	7.20	11	20.00	23.20
04	6.00	9.20	12	22.00	25.20
05	8.00	11.20	13	24.00	27.20
06	10.00	13.20	14	26.00	29.20
07	12.00	15.20	15	28.00	31.20
08	14.00	17.20	16	30.00	33.20
09	16.00	19.20			



1.100

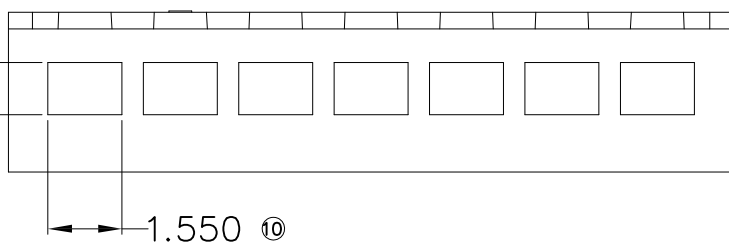

GENERAL TOLERANCE					PARTNO.			
.X ±0.30					9020HR-XX-NOXX			
.XX ±0.20					TITLE			
.XXX ±0.10					2.00mm Crimp Style Connectors			
X.* ±2°					APPROVAL	CHECK	DRAWN	DATE
DATE	REV	ECN NO	DESCRIPTION	MODIFY	APPROVAL	PROJECT	UNIT	SCALE
						Yangzhengguo	mm	1:1
						Yangzhengyi	SHEET	X/X
						Lvtiansheng	REV	A0
						2016/08/26	NUMBER	XXXX



东莞市国亚电子有限公司
Dong Guan Guo Ya Connectors co., ltd.

1

2

3

4

5

6

7

8

A

A

RoHS

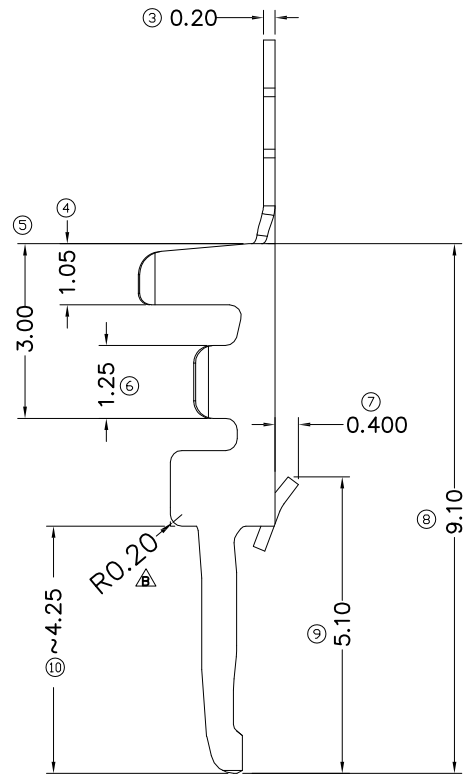
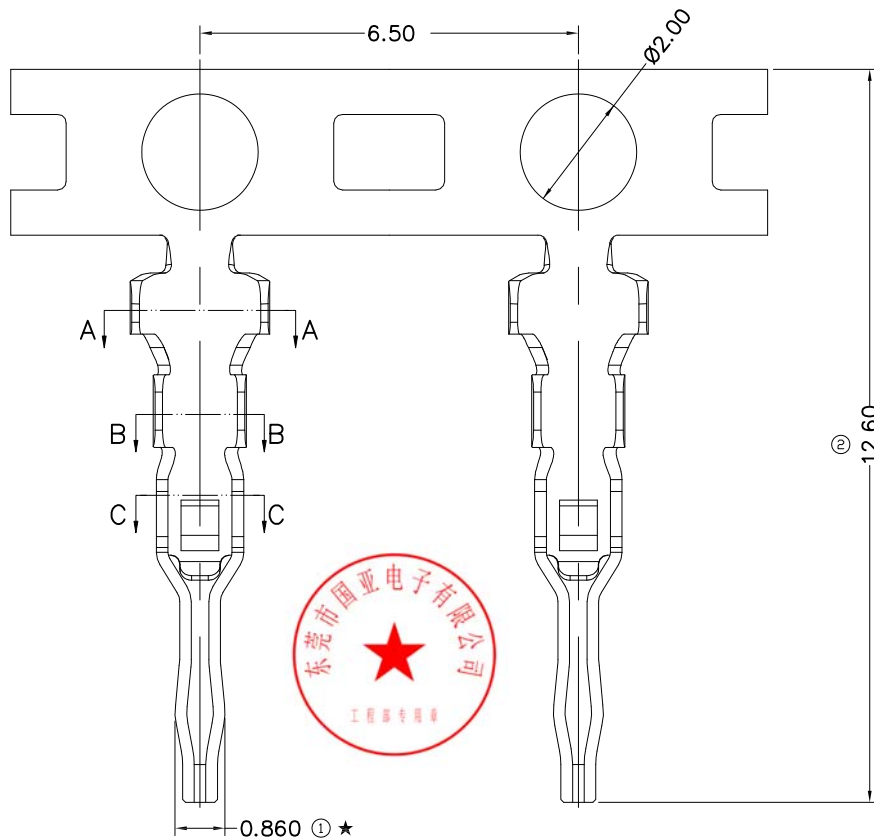

■ Specifications :

- Voltage rating: 250V AC / DC
- Current rating: 2A AC / DC
- Withstanding voltage: 800V AC/minute
- Temperature range: -40° ~+105°
- Insulation resistance: ≥1000MΩ

- Wire Size: AWG#24-26(0.22~0.13mm²)
- Insulation O.D.:1.30mm (Max)
- Used In GYA Housing: 9020HV
- "★" Critical dimension

9020 T V-X SN X - X
① ②③④⑤ ⑥ ⑦

- ①Series Number
- ②Category: T-terminal
- ③Connector type : V-Straight 180°
- ④Material : B-Brass;P-Phosphor Bronze
- ⑤Plating code: SN-Bright tin plating
- ⑥Plating method : Blank-Stamping before plating
- ⑦Mold No./Mark/Special No.

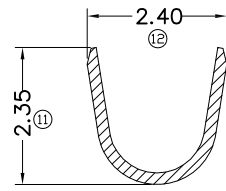

SECTION: A-A
SCALE: 1:1

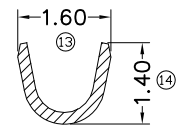

SECTION: B-B
SCALE: 1:1

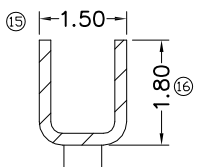

SECTION: C-C
SCALE: 1:1

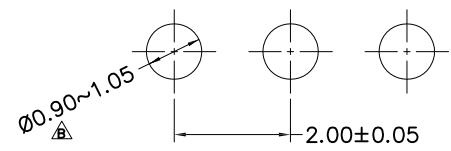

RECOMMENDED P.C.B LAYOUT
(Thickness=1.60mm)

					GENERAL TOLERANCE .X ±0.30 .XX ±0.20 .XXX ±0.10 X.* ±2° PROJECT 				GYA 东莞市国亚电子有限公司 Connectors Dong Guan Guo Ya Connectors co., ltd.				PARTNO. 9020TV-XSN TITLE 2.00mm Crimp Style Connectors			
					APPROVAL Yangzhengguo CHECK Yangzhengyi DRAWN Lviansheng DATE 2016/08/26				UNIT mm SCALE 1:1 SHEET 1/1 REV A0 NUMBER A-014							
DATE	REV	ECN NO	DESCRIPTION	MODIFY	APPROVAL											



RoHS

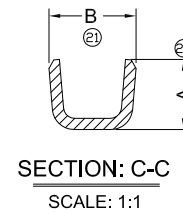
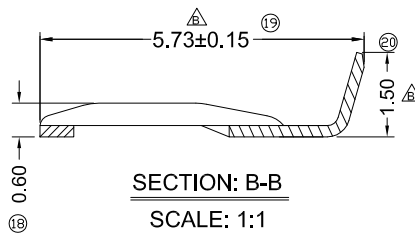
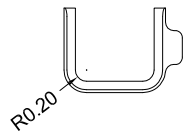
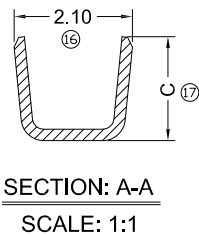
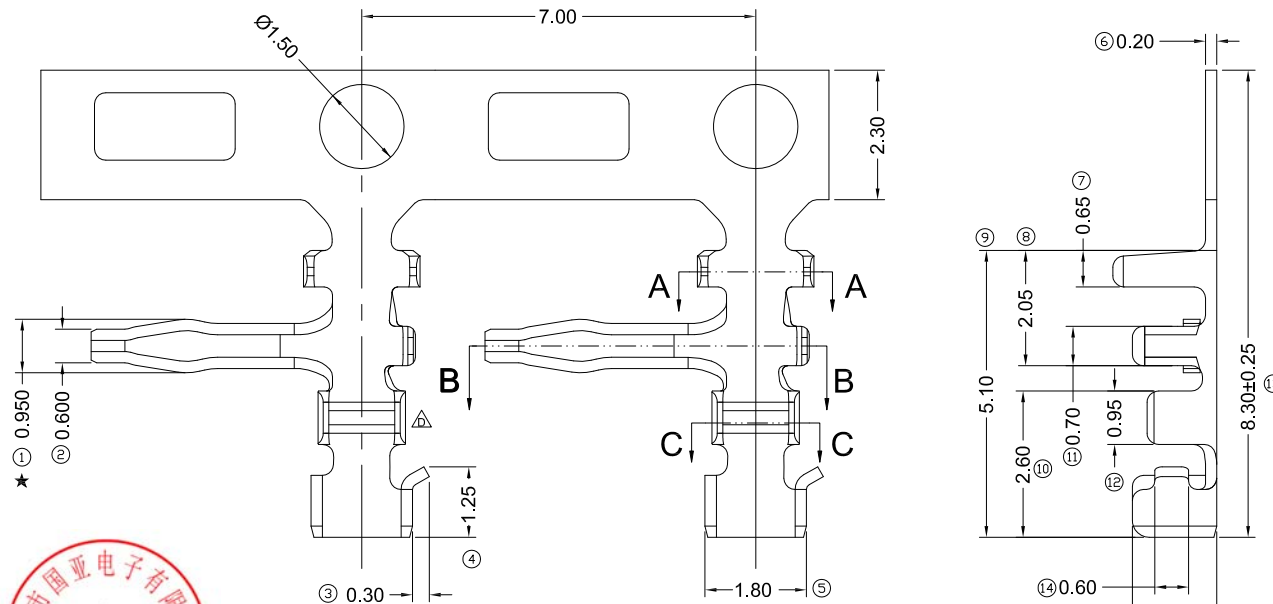

Specifications :

- Voltage rating: 250V AC / DC
- Current rating: 2A AC / DC
- Withstanding voltage: 800V AC/minute
- Temperature range: -40° ~+105°
- Insulation resistance: ≥1000MΩ

- Used In GYA Housing: 9020HR
- "★" Critical dimension

9020 T R-X SN X - X
① ② ③ ④ ⑤ ⑥ ⑦

- ① Series Number
- ② Category: T-terminal
- ③ Connector type: R-Right Angle 90°
- ④ Material: B-Brass;P-Phosphor Bronze
- ⑤ Plating code: SN-Bright tin plating
- ⑥ Plating method: Blank-Stamping before plating
- ⑦ Mold No./Mark/Special No. :
Blank-Ordinary; H-High feet

9020TR-PSN-H	AWG#22~24 0.35~0.22mm ²	1.60mm (Max)	1.60	1.70	2.00
9020TR-PSN	AWG#24~26 0.22~0.13mm ²	1.30mm (Max)	1.25	1.55	1.85
PART NO	Wire Size	Insulation Ø O.D.	DIM A	DIM B	DIM C

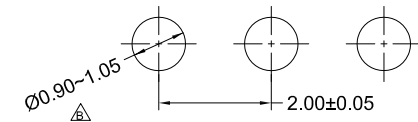

RECOMMENDED P.C.B LAYOUT
(Thickness=1.60mm)

						GENERAL TOLERANCE .X ±0.30 .XX ±0.20 .XXX ±0.10 X.° ±2° PROJECT 				GYA 东莞市国亚电子有限公司 Connectors Dong Guan Guo Ya Connectors co., ltd.				PART NO. 9020TR-XSN-X TITLE 2.00mm Crimp Style Connectors				
DATE	REV	ECN NO	DESCRIPTION	MODIFY	APPROVAL	APPROVAL	CHECK	DRAWN	DATE	UNIT	SCALE	SHEET	REV	NUMBER				
						Yangzhengguo	Yangzhengyi	Lvtiansheng	2016/08/26	mm	1:1	1/1	A0	A-014				