

RoHS

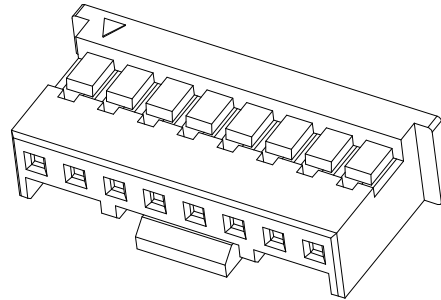
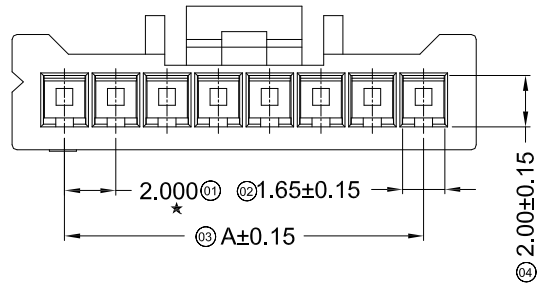

■ Specifications :

- Voltage rating: 250V AC / DC
- Current rating: 3A AC / DC
- Withstanding voltage: 800V AC/minute
- Temperature range: -40° ~+105°
- Insulation resistance: ≥1000MΩ
- Contact resistance: ≤10mΩ
- After environmental testing: ≤20mΩ
- " * " Critical dimension

- Suitable GYA Terminal: 2000T
- Suitable GYA Wafer: 2000W

2000 H X-XX X-N0 XX XX

① ② ③ ④ ⑤ ⑥ ⑦ ⑧

- ① Series No.
- ② Category: H-HSG
- ③ Appearance type : Blank-Ordinary
- ④ Row No.-Pin No.: XX-02P~16P
- ⑤ Plug the Pin & Special No.: Blank-Ordinary
- ⑥ Material : N0-PA66 94V-0
- ⑦ Blank-Ordinary ; HF-Halogen Free
- ⑧ Blank-Natural ; BK-Black; RE-Red

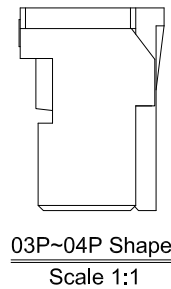
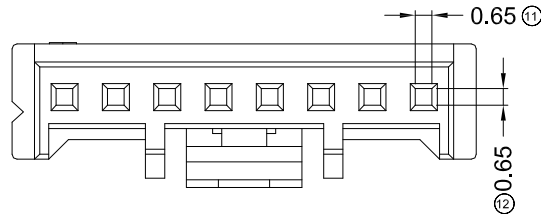
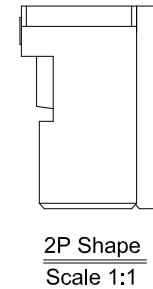
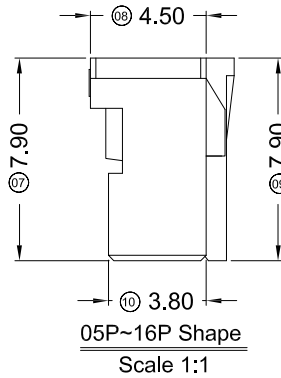
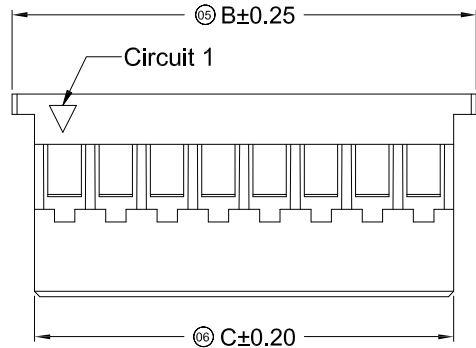

Poles	Dimensions (mm)			Poles	Dimensions (mm)		
	A	B	C		A	B	C
02	2.00	6.10	4.34	10	18.00	22.10	20.34
03	4.00	8.10	6.34	11	20.00	24.10	22.34
04	6.00	10.10	8.34	12	22.00	26.10	24.34
05	8.00	12.10	10.34	13	24.00	28.10	26.34
06	10.00	14.10	12.34	14	26.00	30.10	28.34
07	12.00	16.10	14.34	15	28.00	32.10	30.34
08	14.00	18.10	16.34	16	30.00	34.10	32.34
09	16.00	20.10	18.34				

				GENERAL TOLERANCE		东莞市国亚电子有限公司 Dong Guan Guo Ya Connectors co., Ltd.				PART NO. 2000H-XX-N0XXXX				
				.X ±0.30						TITLE 2.00mm Crimp Style Connector				
				.XX ±0.20						UNIT SCALE SHEET REV NUMBER				
				.XXX ±0.10						mm 1:1 1/1 A0 A-022				
				X.° ±2°		APPROVAL		CHECK		DRAWN		DATE		
DATE				REV		ECN NO		DESCRIPTION		MODIFY		APPROVAL		
PROJECT				PROJECT		Yangzhengguo		Yangzhengyi		Lvtiansheng		2016/08/26		

1 2 3 4 5 6 7 8

RoHS

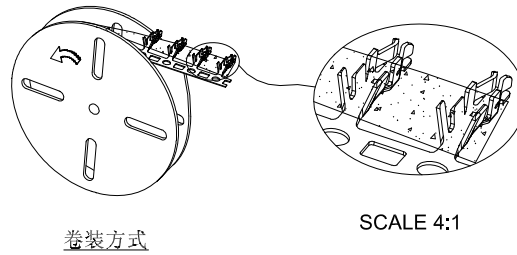
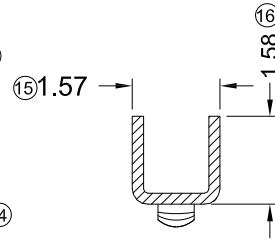
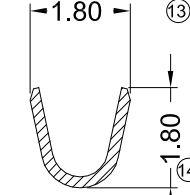
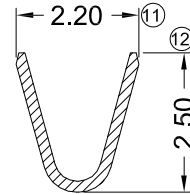
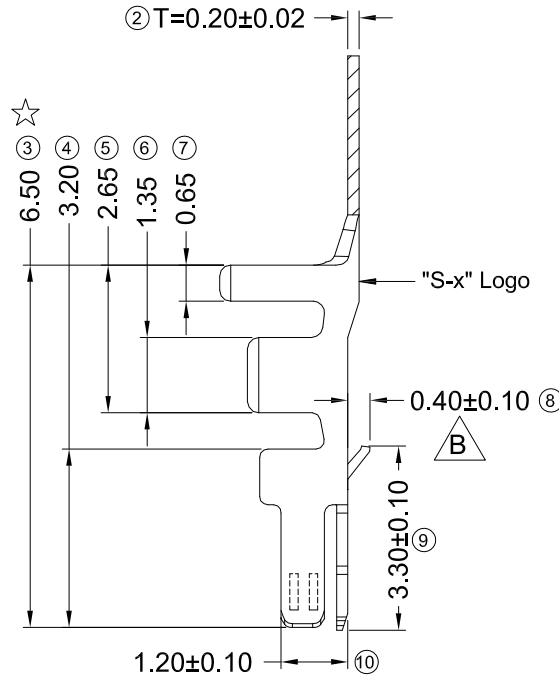
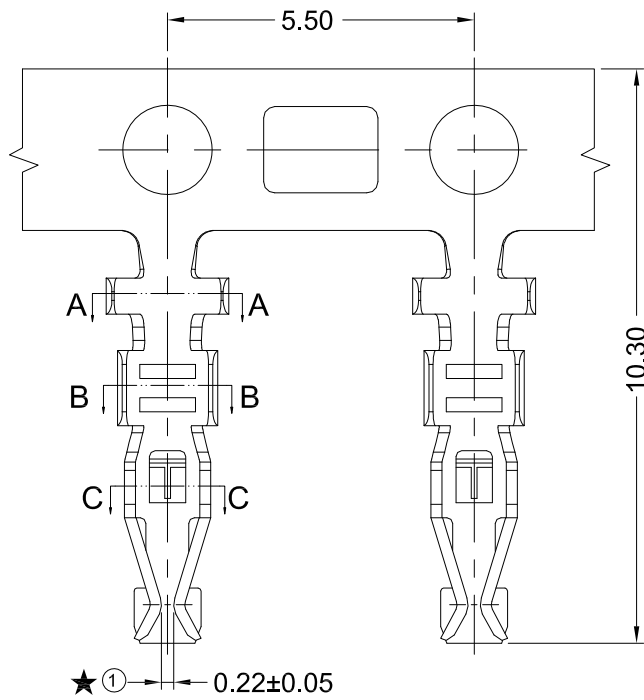

■ Specifications :

- Voltage rating: 250V AC / DC
- Current rating: 3A AC / DC
- Withstanding voltage: 800V AC/minute
- Temperature range: -40° ~+125°
- Insulation resistance: ≥1000MΩ
- Contact resistance: ≤10mΩ
- After environmental testing: ≤20mΩ
- Used In GYA Housing:2000H
- "★" Represents special characteristics
- "☆" Represents critical characteristics
- Special characteristics and critical characteristics according to 《control plan》

2000 T H-H SN

① ② ③ ④ ⑤

- ① Series No.
- ② Category: T-Terminal
- ③ Appearance type: H-High feet;
- ④ Material: H-Copper Alloy(CuNi3Si1Mg)
- ⑤ Plating Style: SN-Bright Tin Plating
Ni:1~3um(40~120u")
Sn:2~5um(80~200u")



	Document/drawing name	Rev
Product Specification	PS-2000-01	B
Assembly Specification	ED-3-04-006	A
Package Specification	2000TH-HSN 2.00mm Terminal Packing	A
Crimp Specification	2.00mm Pitch Wire to Board Series Terminal	G

2000TH-HSN	Copper Alloy(CuNi3Si1Mg)	0.35~0.53mm ²	1.50mm(Max)	2.20	2.50	1.80	1.80	2000H
PART NO	Material	Wire Size	Insulation O.D	DIM a	DIM b	DIM c	DIM d	Used In GYA Housing

GENERAL TOLERANCE

- .X ±0.35
- .XX ±0.25
- .XXX ±0.15
- X.° ±2°

PROJECT

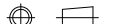

东莞市国亚电子有限公司
Dong Guan Guo Ya Connectors co., ltd.

APPROVAL CHECK DRAWN DATE

Yangzhengguo Yangzhengyi Lvtiansheng 2016/08/26

PART NO. 2000TH-HSN

TITLE 2.00mm Crimp Style Connectors

UNIT	SCALE	SHEET	REV	NUMBER
mm	1:1	1/1	A0	A-014

DATE	REV	ECN NO	DESCRIPTION	MODIFY	APPROVAL
1					
2					
3					
4					

RoHS

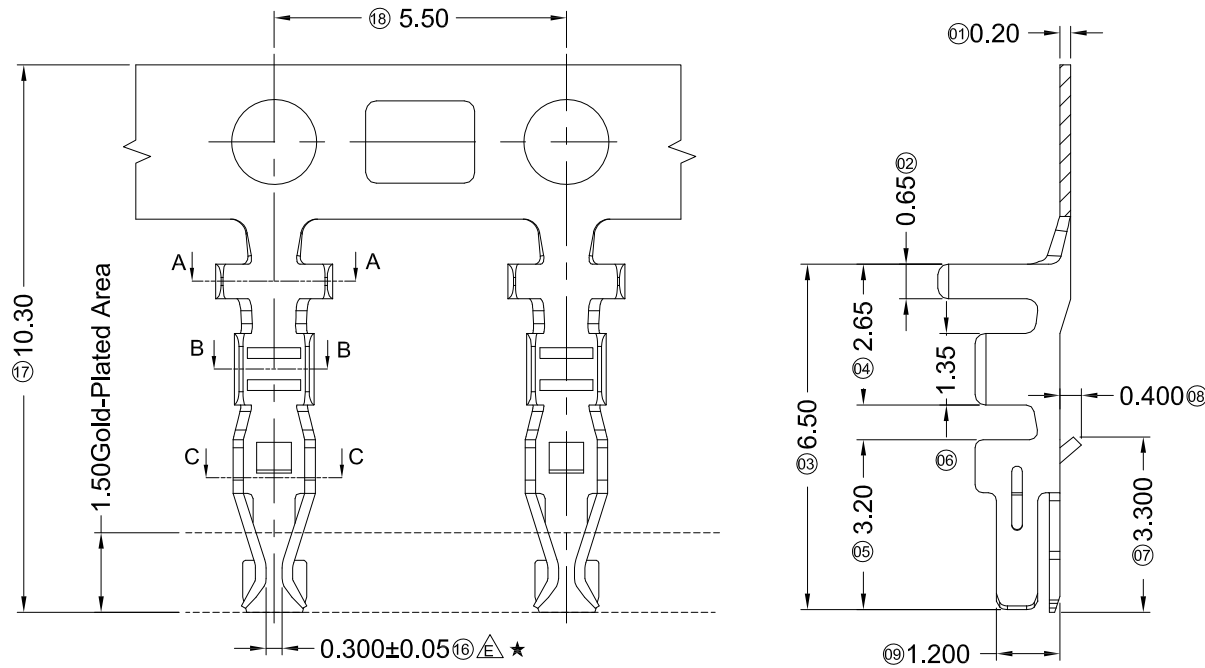

■ Specifications :

- Voltage rating: 250V AC / DC
- Current rating: 3A AC / DC
- Withstanding voltage: 800V AC/minute
- Temperature range: -40° ~+105°
- Insulation resistance: ≥1000MΩ
- Contact resistance: ≤10mΩ
- After environmental testing: ≤20mΩ
- Used In GYA Housing:2000H
- "★" Critical dimension

2000 T X-P XX X-X
① ② ③ ④ ⑤ ⑥ ⑦

- ① Series No.
- ② Category : T-Terminal
- ③ Appearance type :
Blank-Ordinary; H-High feet; L-Low feet
- ④ Material: P-Phosphor bronze
- ⑤ Plating Code: G01-Contact Gold 1u"
G03-Contact Gold 3u"
SN-Bright Tin Plating
- ⑥ Plating Method : Blank-Stamping before Plating
- ⑦ Mold No./Mark/Special No.

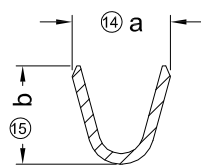

SECTION: A-A
SCALE: 1:1

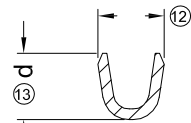

SECTION: B-B
SCALE: 1:1

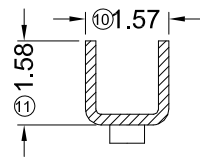

SECTION: C-C
SCALE: 1:1

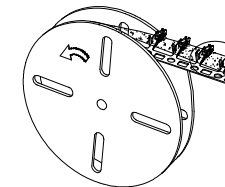

卷装方式

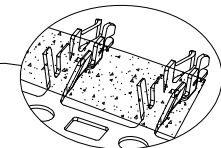

SCALE 4:1

P/N	Material	Wire Size	Insulation O.D	DIM a	DIM b	DIM c	DIM d
2000TH-PXXX	Phosphor bronze	AWG#20-22 (0.5-0.35mm ²)	1.50mm(Max)	2.20	2.50	1.80	1.80
2000T-PXXX		AWG#22-24 (0.35-0.22mm ²)	1.50mm(Max)	2.20	2.50	1.50	1.60
2000TL-PXXX		AWG#28-32	1.00mm(Max)	1.85	1.85	1.25	1.25

DATE	REV	ECN NO	DESCRIPTION	MODIFY	APPROVAL

GENERAL TOLERANCE	
.X	±0.30
.XX	±0.20
.XXX	±0.10
X.°	±2°
PROJECT	

	东莞市国亚电子有限公司 Dong Guan Guo Ya Connectors co., ltd.			
	APPROVAL	CHECK	DRAWN	DATE
	Yangzhengguo	Yangzhengyi	Lvtiansheng	2016/08/26

PART NO. 2000TX-PXX				
TITLE 2.00mm Crimp Style Connectors				
UNIT	SCALE	SHEET	REV	NUMBER
mm	1:1	1/1	A0	A-014

RoHS

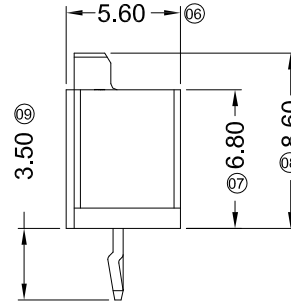
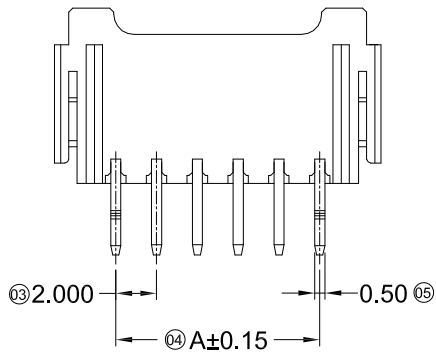
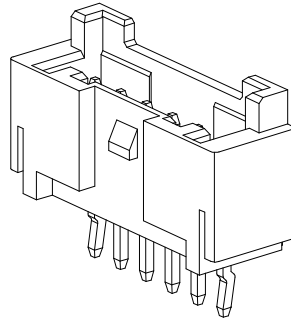
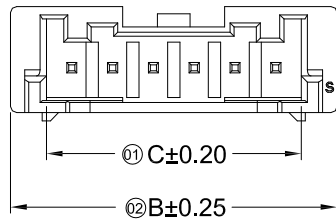

Specifications :

- Voltage rating: 250V AC / DC
- Current rating: 3A AC / DC
- Withstanding voltage: 800V AC/minute
- Temperature range: -40° ~+105°
- Insulation resistance: ≥1000MΩ
- Contact resistance: ≤10mΩ
- After environmental testing: ≤20mΩ
- Material(Pin): Brass
- Mates With GYA Housing: 2000H



2000 W V X-XX X -9T SN XX
① ② ③ ④ ⑤ ⑥ ⑦ ⑧ ⑨

- ① Series No.
- ② Category: W-WAFER
- ③ Welding Board Angle : V- Stright 180° ;
- ④ Welding Way: Blank-DIP
- ⑤ Row No.-Pin No.: XX-02P~16P
- ⑥ Plug the Pin & Special No.: With Kink
- ⑦ Material: 9T -PA9T 94V-0
- ⑧ Plating Category: SN-Bright Tin Plating
- ⑨ Color : Blank-Natural Color

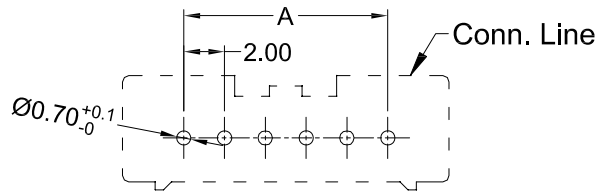

Recommended P.C.B Layout
General Tolerance±0.05

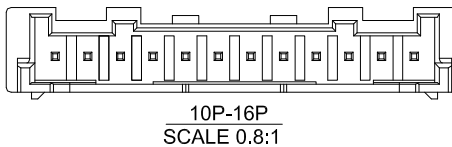
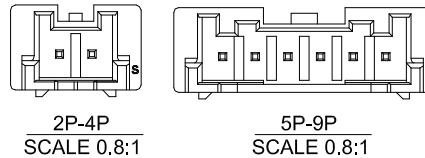

Poles	Dimensions (mm)			Poles	Dimensions (mm)		
	A	B	C		A	B	C
02	2.00	8.00	4.50	10	18.00	24.00	20.50
03	4.00	10.00	6.50	11	20.00	26.00	22.50
04	6.00	12.00	8.50	12	22.00	28.00	24.50
05	8.00	14.00	10.50	13	24.00	30.00	26.50
06	10.00	16.00	12.50	14	26.00	32.00	28.50
07	12.00	18.00	14.50	15	28.00	34.00	30.50
08	14.00	20.00	16.50	16	30.00	36.00	32.50
09	16.00	22.00	18.50				

DATE	REV	ECN NO	DESCRIPTION	MODIFY	APPROVAL	PROJECT	APPROVAL	CHECK	DRAWN	DATE	UNIT	SCALE	SHEET	REV	NUMBER
						Yangzhengguo	Yangzhengyi	Lvtiansheng		2016/08/26	mm	1:1	1/1	A0	A-000

GENERAL TOLERANCE

- .X ±0.30
- .XX ±0.20
- .XXX ±0.10
- X.° ±2°



东莞市国亚电子有限公司
Dong Guan Guo Ya Connectors co., ltd.

PART NO.
2000WV-XX-9TSN

TITLE
2.00mm Crimp Style Connector

RoHS

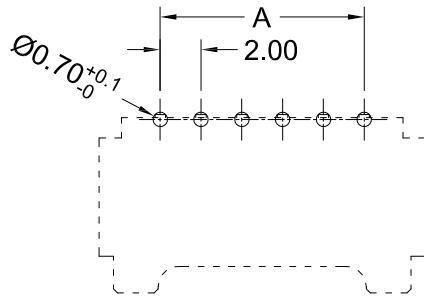
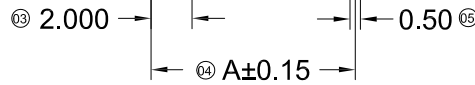
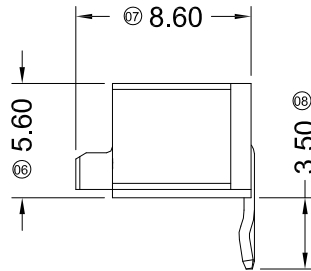
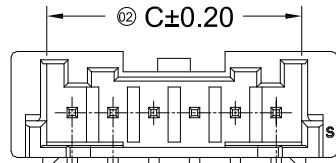
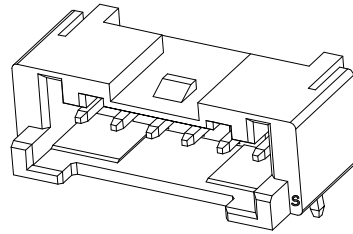
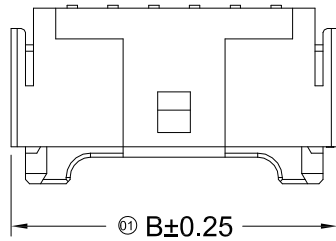

Recommended P.C.B Layout
General Tolerance ±0.05

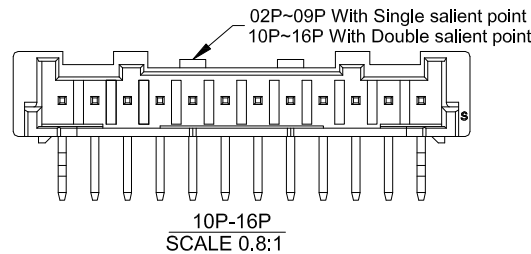
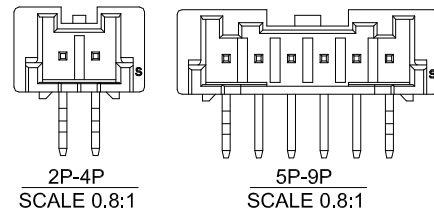

Specifications :

- Voltage rating: 250V AC / DC
- Current rating: 3A AC / DC
- Withstanding voltage: 800V AC/minute
- Temperature range: -40° ~+105°
- Insulation resistance: ≥1000MΩ
- Contact resistance: ≤10mΩ
- After environmental testing: ≤20mΩ
- Material(Pin): Brass
- Mates With GYA Housing: 2000H

2000 W R X-XX X -9T SN XX
① ② ③ ④ ⑤ ⑥ ⑦ ⑧ ⑨



- ① Series No.
- ② Category: W-WAFER
- ③ Welding Board Angle : R-Right Angle 90°
- ④ Welding Way: Blank-DIP
- ⑤ Row No.-Pin No.: XX-02P~16P
- ⑥ Plug the Pin & Special No.
- ⑦ Material: 9T -PA9T 94V-0
- ⑧ Plating Code: SN-Bright Tin Plating
- ⑨ Color : Blank-Natural Color

Poles	Dimensions (mm)			Poles	Dimensions (mm)		
	A	B	C		A	B	C
02	2.00	8.00	4.50	10	18.00	24.00	20.50
03	4.00	10.00	6.50	11	20.00	26.00	22.50
04	6.00	12.00	8.50	12	22.00	28.00	24.50
05	8.00	14.00	10.50	13	24.00	30.00	26.50
06	10.00	16.00	12.50	14	26.00	32.00	28.50
07	12.00	18.00	14.50	15	28.00	34.00	30.50
08	14.00	20.00	16.50	16	30.00	36.00	32.50
09	16.00	22.00	18.50				

DATE	REV	ECN NO	DESCRIPTION	MODIFY	APPROVAL	PROJECT	APPROVAL	CHECK	DRAWN	DATE	UNIT	SCALE	SHEET	REV	NUMBER
						Yangzhengguo		Yangzhengyi	Lvtiansheng	2016/08/26	mm	1:1	1/1	A0	A-000

GENERAL TOLERANCE

- .X ±0.30
- .XX ±0.20
- .XXX ±0.10
- X.° ±2°



东莞市国亚电子有限公司
Dong Guan Guo Ya Connectors co., ltd.

PART NO.
2000WR-XX-9TSN

TITLE
2.00mm Crimp Style Connector

RoHS

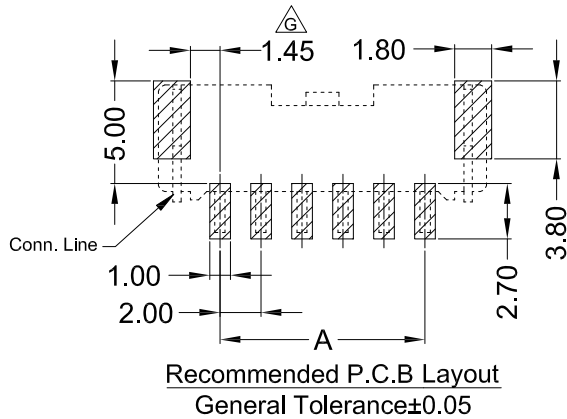
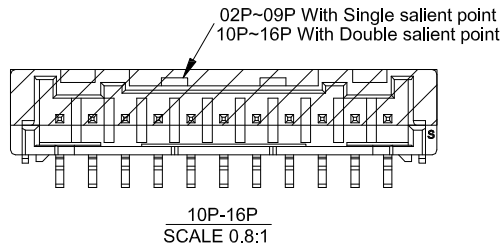
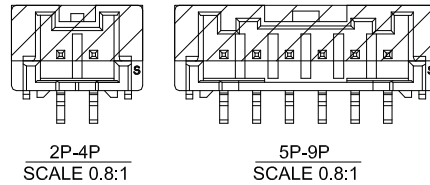
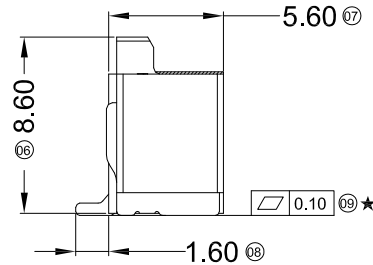
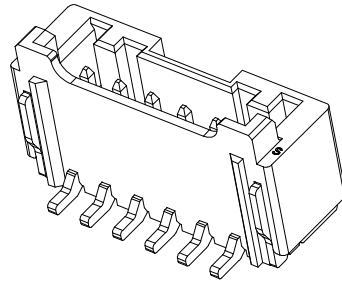
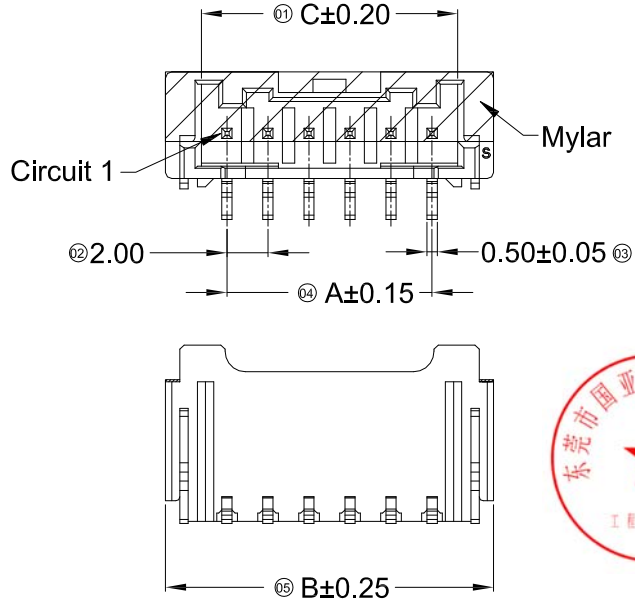

■ Specifications :

- Voltage rating: 250V AC / DC
- Current rating: 3A AC / DC
- Withstanding voltage: 800V AC/minute
- Temperature range: -40° ~+105°
- Insulation resistance: ≥1000M Ω
- Contact resistance: ≤10m Ω
- After environmental testing : ≤20m Ω
- Material(Pin) : Brass
- Material(Solder Tabs) : Brass
- Mates With GYA Housing : 2000H
- "★" Critical dimension

2000 W V S-XX X -9T SW XX X
 ① ② ③ ④ ⑤ ⑥ ⑦ ⑧ ⑨ ⑩

- ① Series No.
- ② Category: W-WAFER
- ③ Connector type: V-Stright 180°
- ④ Mouting type: S-SMT
- ⑤ Row No.-Pin No per row: XX-02P~16P
- ⑥ Plug the Pin & Special No.
- ⑦ Material: 9T -PA9T 94V-0 LP-LCP 94V-0
- ⑧ Plating Code: SN-Bright Tin ; SW-Matte Tin
- ⑨ Color : Blank-Natural Color
- ⑩ Packing: Blank-Reel ,With Mylar R-Reel ,Without Mylar

Poles	Dimenstons (mm)			Poles	Dimenstons (mm)		
	A	B	C		A	B	C
02	2.00	8.00	4.50	10	18.00	24.00	20.50
03	4.00	10.00	6.50	11	20.00	26.00	22.50
04	6.00	12.00	8.50	12	22.00	28.00	24.50
05	8.00	14.00	10.50	13	24.00	30.00	26.50
06	10.00	16.00	12.50	14	26.00	32.00	28.50
07	12.00	18.00	14.50	15	28.00	34.00	30.50
08	14.00	20.00	16.50	16	30.00	36.00	32.50
09	16.00	22.00	18.50				

DATE	REV	ECN NO	DESCRIPTION	MODIFY	APPROVAL
1					
2					
3					
4					
5					

GENERAL TOLERANCE	
.X	±0.30
.XX	±0.20
.XXX	±0.10
X.°	±2°
PROJECT	
①	②



东莞市国亚电子有限公司
 Dong Guan Guo Ya Connectors co., ltd.

APPROVAL	CHECK	DRAWN	DATE
Yangzhengguo	Yangzhengyi	Lvtiansheng	2016/08/26

PART NO.				
2000WVS-XX-XXSWXXX				
TITLE				
2.00mm Crimp Style Connector				
UNIT	SCALE	SHEET	REV	NUMBER
mm	1:1	1/1	A0	A-000

RoHS

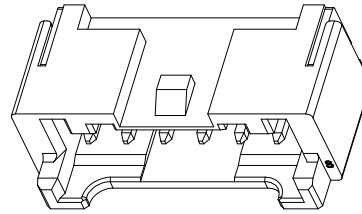
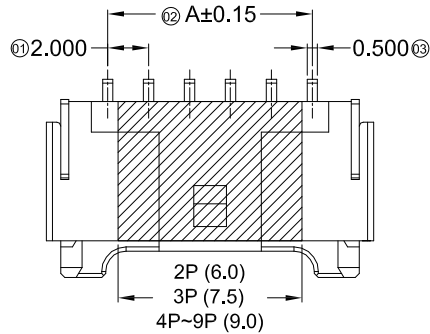

Specifications :

- Voltage rating: 250V AC / DC
- Current rating: 3A AC / DC
- Withstanding voltage: 800V AC/minute
- Temperature range: -40° ~+105°
- Insulation resistance: ≥1000MΩ
- Contact resistance: ≤10mΩ
- After environmental testing : ≤20mΩ

- Material(Pin) : Brass
- Material(Solder Tabs) : Brass
- Mates With GYA Housing : 2000H

2000 W R S-XX X -XX SW XX X
 ① ② ③ ④ ⑤ ⑥ ⑦ ⑧ ⑨ ⑩

- ① Series No.
- ② Category : W-WAFER
- ③ Connector type : R-Right Angle 90°
- ④ Mounting type: S-SMT
- ⑤ Row No.-Pin No per row: XX-02P~16P
- ⑥ Special No.
- ⑦ Material: 9T -PA9T 94V-0; LP -LCP 94V-0
- ⑧ Plating code: SW- Matte Tin
- ⑨ Color : Blank-Natural Color ; BK-Black Color
- ⑩ Packing: Blank-Reel ,With Mylar
R-Reel ,Without Mylar

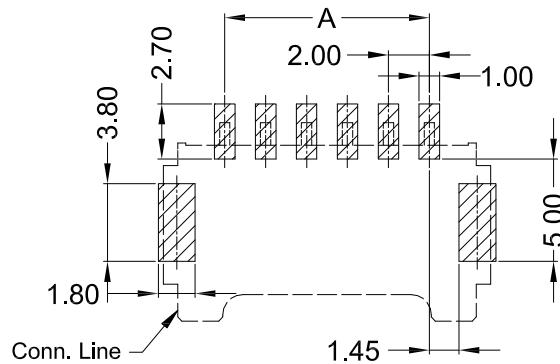
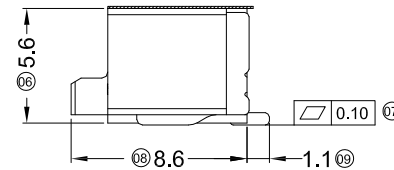
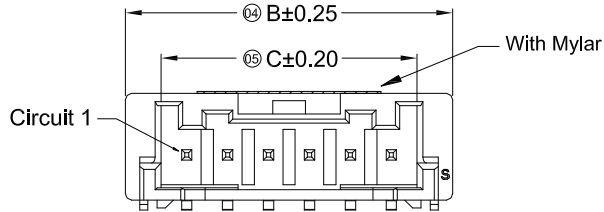

Recommended P.C.B Layout
 General Tolerance±0.05

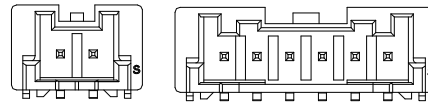

2P-4P SCALE 1:0.8
 5P-9P SCALE 1:0.8

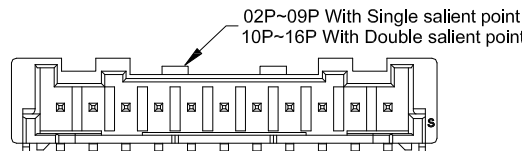

10P-16P SCALE 1:0.8

Poles	Dimensions (mm)			Poles	Dimensions (mm)		
	A	B	C		A	B	C
02	2.00	8.00	4.50	10	18.00	24.00	20.50
03	4.00	10.00	6.50	11	20.00	26.00	22.50
04	6.00	12.00	8.50	12	22.00	28.00	24.50
05	8.00	14.00	10.50	13	24.00	30.00	26.50
06	10.00	16.00	12.50	14	26.00	32.00	28.50
07	12.00	18.00	14.50	15	28.00	34.00	30.50
08	14.00	20.00	16.50	16	30.00	36.00	32.50
09	16.00	22.00	18.50				

GENERAL TOLERANCE

- .X ±0.30
- .XX ±0.20
- .XXX ±0.10
- X.° ±2°

PROJECT



东莞市国亚电子有限公司
 Dong Guan Guo Ya Connectors co., ltd.

APPROVAL CHECK DRAWN DATE

Yangzhengguo Yangzhengyi Lvtiansheng 2016/08/26

PART NO.

2000WRS-XX-XXSWXXX

TITLE

2.00mm Crimp Style Connector

UNIT	SCALE	SHEET	REV	NUMBER
mm	1:1	1/1	A0	A-000

DATE	REV	ECN NO	DESCRIPTION	MODIFY	APPROVAL
1					
2					
3					
4					
5					